

TOWNSHIP 4 SOUTH, RANGE 3 WEST, W.M.

WEST FORK PALMER CREEK
 THESE MAPS ARE SCHEMATIC UTILITY MAPS ONLY & DO NOT SHOW EXACT LOCATIONS OF UTILITIES. VERIFY ALL LOCATIONS PRIOR TO DESIGN OR CONSTRUCTION.

- LEGEND**
- 8" CL. WATERLINE
 - VALVE
 - BLOW-OFF
 - FIRE HYDRANT
 - MUNICIPAL WELL
 - AIR RELEASE VALVE
 - AC CASSETS/CONCRETE
 - DL DUCTILE IRON
 - STL STEEL
 - GLV GALVANIZED IRON
 - COP COPPER
 - VALVE NUMBER
 - STORZ ADAPTER ON STEAMER PORT NUMBER OF PORTS
 - FIRE HYDRANT NUMBER
 - SPECIAL CONNECTION # (2004 NOTEBOOK)
 - APPROXIMATE WATER METER LOCATION
 - PROPERTY SERVED BY "CROSS-CITY-LIMITS" WATER SERVICE

LEGEND

- 8" CL. WATERLINE
- VALVE
- BLOW-OFF
- FIRE HYDRANT
- MUNICIPAL WELL
- AIR RELEASE VALVE
- AC CASSETS/CONCRETE
- DL DUCTILE IRON
- STL STEEL
- GLV GALVANIZED IRON
- COP COPPER
- VALVE NUMBER
- STORZ ADAPTER ON STEAMER PORT NUMBER OF PORTS
- FIRE HYDRANT NUMBER
- SPECIAL CONNECTION # (2004 NOTEBOOK)
- APPROXIMATE WATER METER LOCATION
- PROPERTY SERVED BY "CROSS-CITY-LIMITS" WATER SERVICE

GRAPHIC SCALE

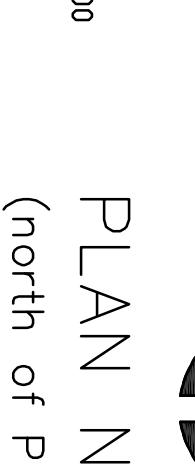

PLAN NORTH
 (north of Palmer Creek)

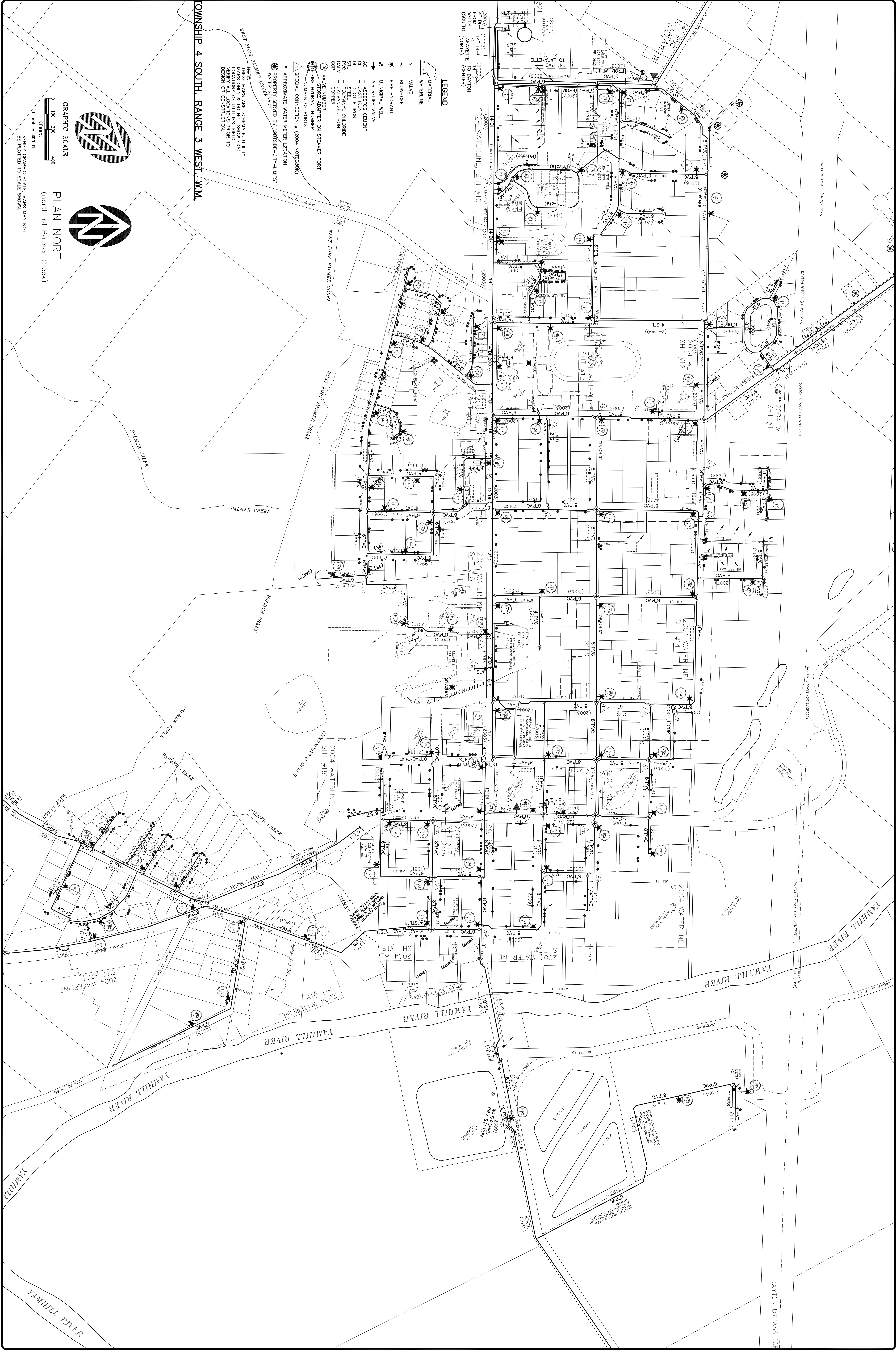
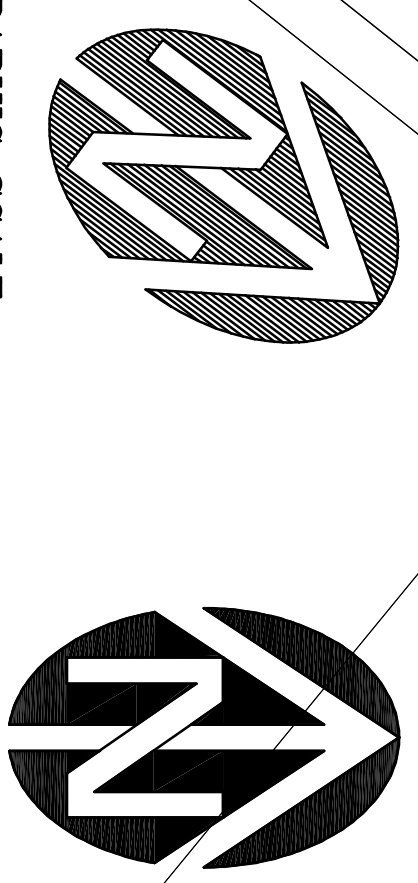

CITY OF DAYTON, OREGON	WATER SYSTEM MAP	<p>WESTTECH ENGINEERING, INC. CONSULTING ENGINEERS AND PLANNERS 3841 Fairview Industrial Dr. S.E., Suite 100, Salem, OR 97302 Phone: (503) 585-2474 Fax: (503) 585-3986 E-mail: westech@westech-eng.com</p>	MAP UPDATED: 1-12-2021	SCALE HORIZ: VERIFY SCALE BAR IS ONE INCH ON DRAWING VERT: 0" = 10' (VERTICAL) THIS SHEET, UNLESS OTHERWISE NOTED, SHALL BE PLOTTED AS SHOWN ACCORDINGLY.	DATE: AUG 2006	NO. DATE DESCRIPTION BY
SHEET 1 OF 1	JOB NUMBER 2609.1006.0					